

1
SP 131918

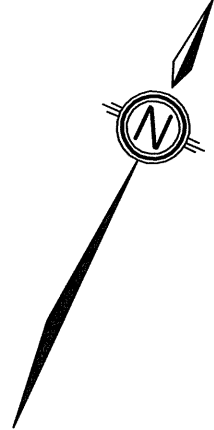
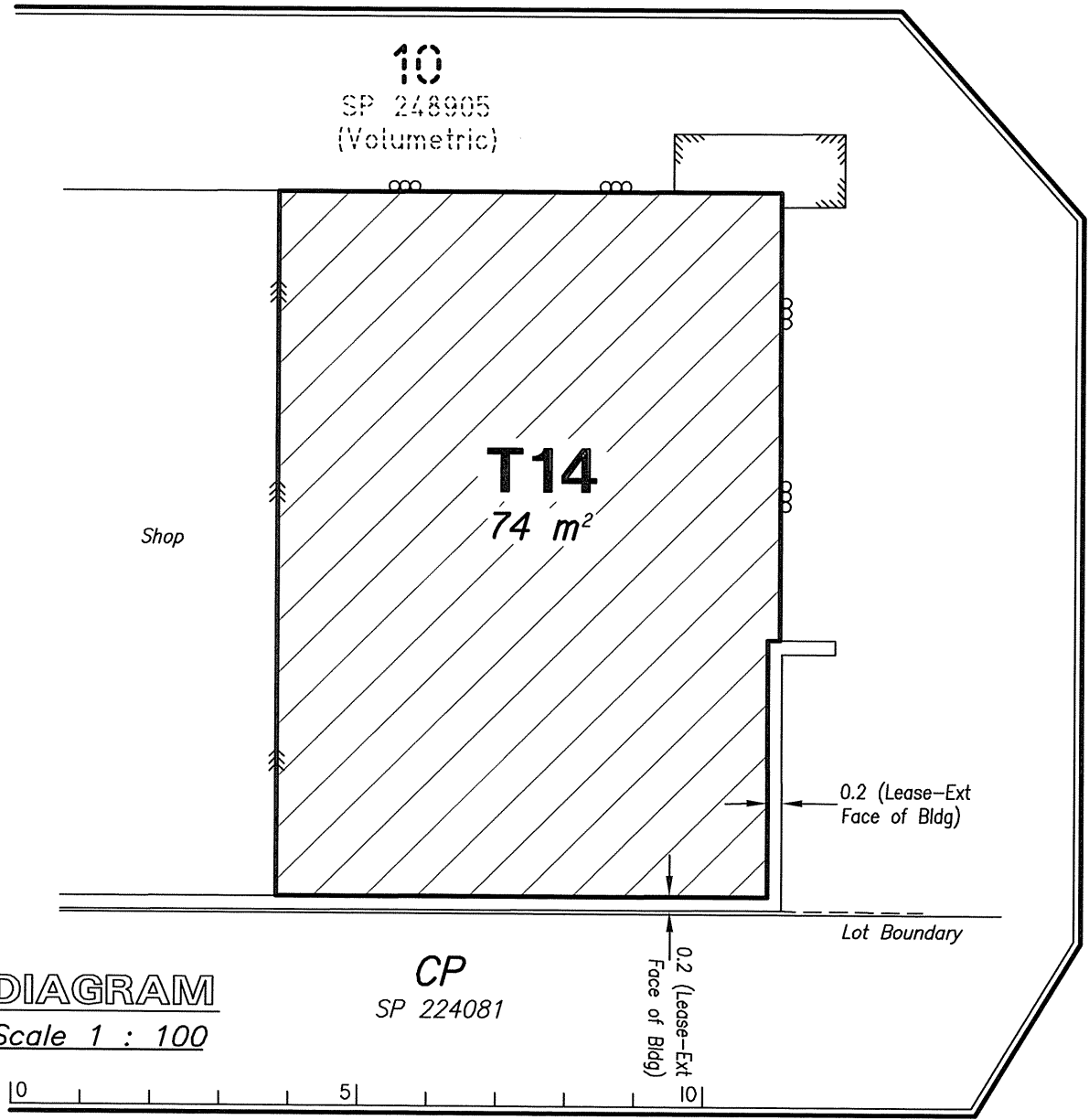
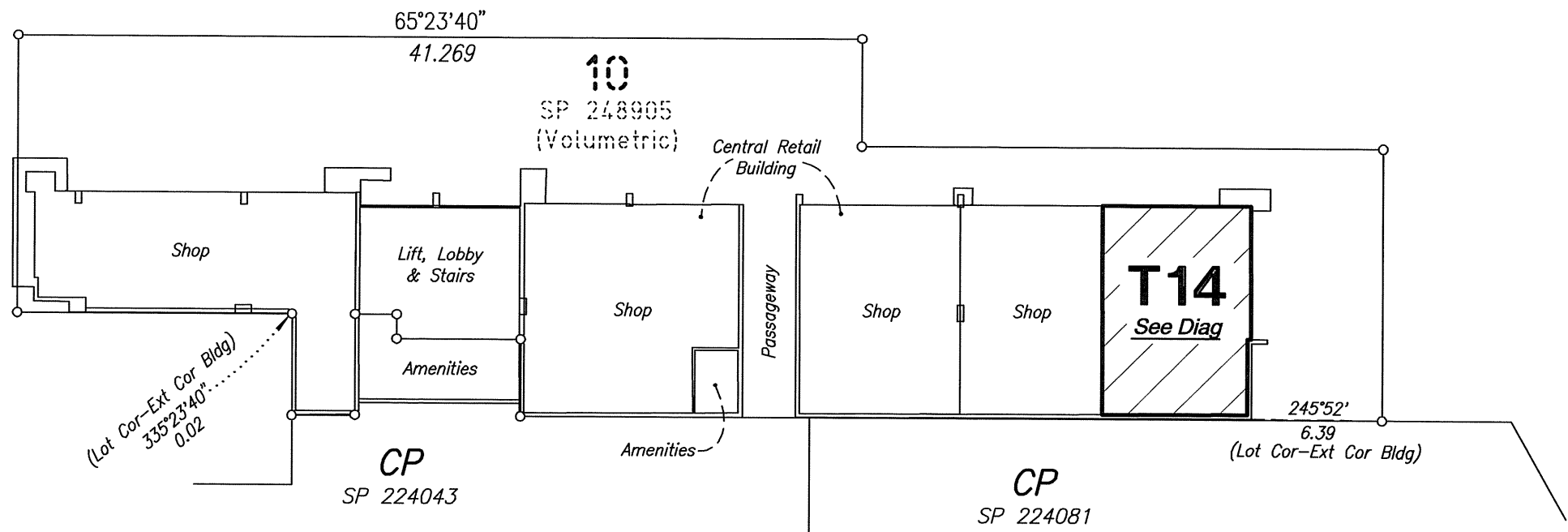

--- denotes Aluminum Strip at Edge of Tiles on Floor (Coincident with Step in Floor Slab)
 --- denotes Centreline of Wall

Note
 Lease Area is a "Gross Lettable Area-Retail" as defined in the Property Council of Australia's "Method of Measurement for Lettable Area" (©1997).

Lease area defined by structural elements being Internal Face of Conc Walls unless shown otherwise.

Lease Area Shown Hachured.

For clarity only adjoining information that exists at this floor level is shown.

DWG: 22151Lease.dwg

Surv:	WJB	Scale:	1:300 @ A3
Date:	3/4/2013	Ref #	22151-50A



RPS Australia East Pty Ltd
 ACN 140 292 762
 ABN 44 140 292 762
 743 Ann Street
 PO Box 1559
 Fortitude Valley QLD 4006
 T +61 7 3237 8899
 F +61 7 3237 8833
 W rpsgroup.com.au

© COPYRIGHT PROTECTS THIS PLAN
 Unauthorised reproduction or amendment
 not permitted. Please contact the author.

PLAN FOR LEASE PURPOSES

Over Part of the Ground Floor of a Building situated on the land contained in the Certificate of Title 50904181 Being Lot 10 (Vol) on SP 248905 Parish of Toombul County of Stanley Locality of Hamilton

We, RPS Australia East Pty Ltd (ACN 140 292 762), Cadastral Surveyor, certify that the details shown on this sketch plan are correct.

[Signature]
 Authorised Delegate
 3.4.13
 Date